



Sapphire Gardens

 **510
EARTH**
TOP PROPERTY | BEST DEALS



DREAM
COMES
REAL



Sapphire
Gardens



Sapphire
Gardens

Rajarhate Projar Bass





Sapphire
Gardens

We have always worked around a set of “value” principles. Give people good value for their money. Always deliver products that have value additions. Be genuine and transparent in our dealings with customers. Ensure that customers do not simply buy a home from us; they buy peace-of-mind.

These values have seen us create project after successful project, providing more, better homes for more people. Maple Heights, Emerald Gardens, Jasmine Heights, Fortune Square, projects like these bear testimony to our capability and our commitment.

**YOU CAN ALWAYS PUT YOUR TRUST IN
REALTECH GROUP**

True to its ongoing commitment to the people of kolkata and surrounds. Realtech Group presents yet another, wonderfully livable, beautifully built block of just 6 Apartments in excellent environments.



TECHNICAL DETAILS

Structure: *RCC with bricks*

Walls

Internal: POP finish

External: High quality waterproof acrylic paint

Floors: *Kota stone / vitrified tiles / cosmic tiles*

Electrical: *Concealed copper wiring with modular switches, adequate light & power points, standard main DB with MCB, TV/Telephone points.*

Kitchen: *Dado of ceramic tiles up to the height of 30 inches above the cooking platform of green marble, stainless steel sink with drain board*

Toilet: *Concealed pipeline, ceramic tiles dado up to the height of door frame level, CP bath fittings, white sanitary fittings, PVC cisterns of reputed make with ISI mark.*

Doors: *Water proof flush door in paint finish*

Windows: *Sliding aluminium windows with clear glass panes.*

Lift: *Six/four passenger lift.*

Water: *24 hour water supply.*

Generator: *24 hour power backup for common area lighting. Available at nominal charges for each flat.*

Security services: *24 hour security services.*



Sapphire
Gardens

 **510
EARTH**
TOP PROPERTY | BEST DEALS



The essence of design will always be about people and how they live. It is about the realities of what makes for an attractive civilized meaningful environment, not about fashion or what's in or out.

Sapphire
Gardens

PROFESSIONALISM
DEDICATION





*Decorating is the art of arranging
beautiful thing comfortable.
Our project represents timeless values
meticulously adhered to by our designers.....*

Sapphire
Gardens

INNOVATION
DIVERSITY





Sapphire Gardens



STYLISH
DESIGN

*You shape your environment
and then it shapes you.*



Our vision extends for deeper than our imagination boldly met by our passion...

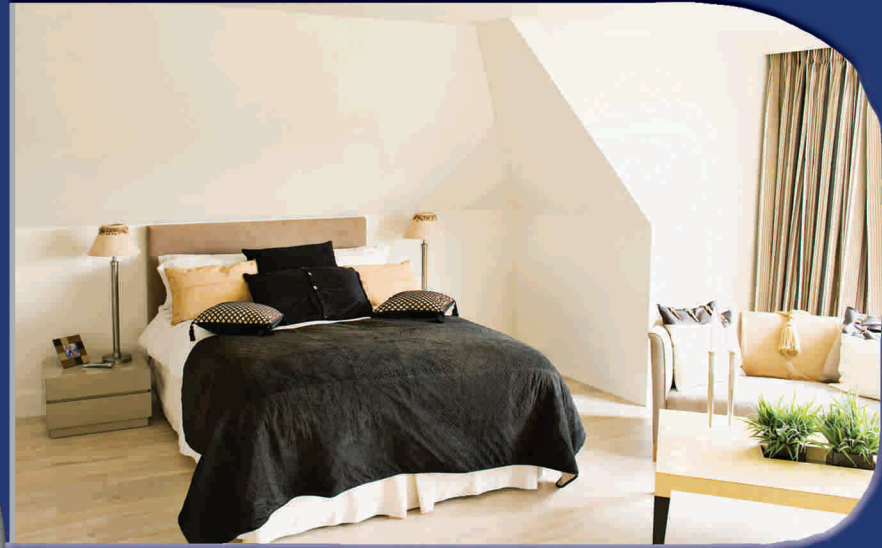

Sapphire Gardens



UNIQUE
CREATIVE

 **510
EARTH**
TOP PROPERTY | BEST DEALS

Sapphire Gardens



LOCATION MAP



- *2/3 BHK (753 - 1195)sqft*
- *Open Area*
- *Natural Water Body*
- *All Modern Amenities*
- *Visitor Car Park*
- *Power Back up*
- *AC Gym*
- *Community Hall*

AMENITIES

GROUND FLOOR PLAN

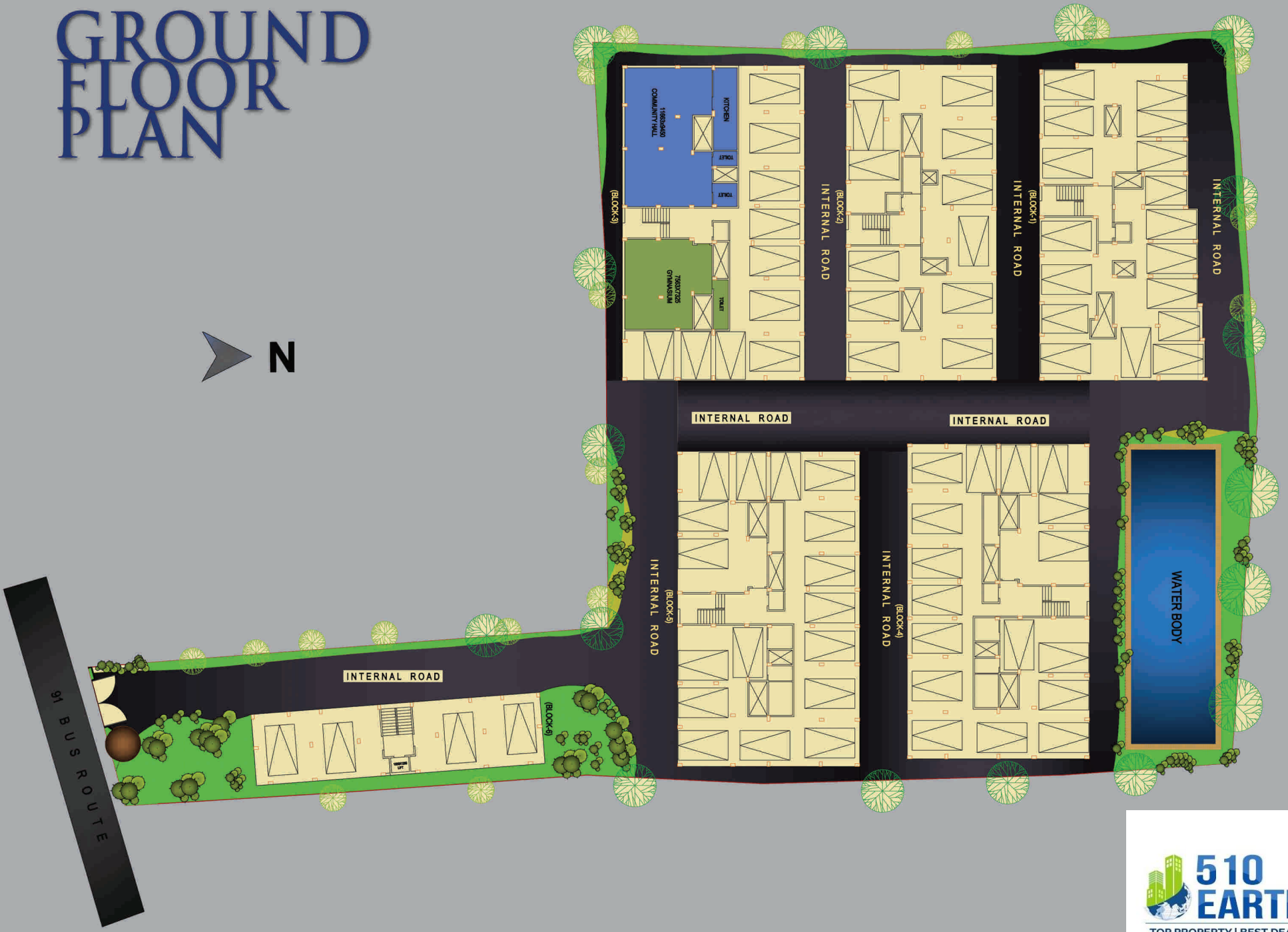
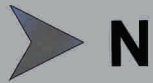



TYPICAL FLOOR PLAN OF BLOCK - 1



TYPICAL FLOOR PLAN OF BLOCK - 2



F-838 SQ.FT | G-753 SQ.FT | H-839 SQ.FT | I-939 SQ.FT | J-966 SQ.FT



TYPICAL FLOOR PLAN OF BLOCK - 3

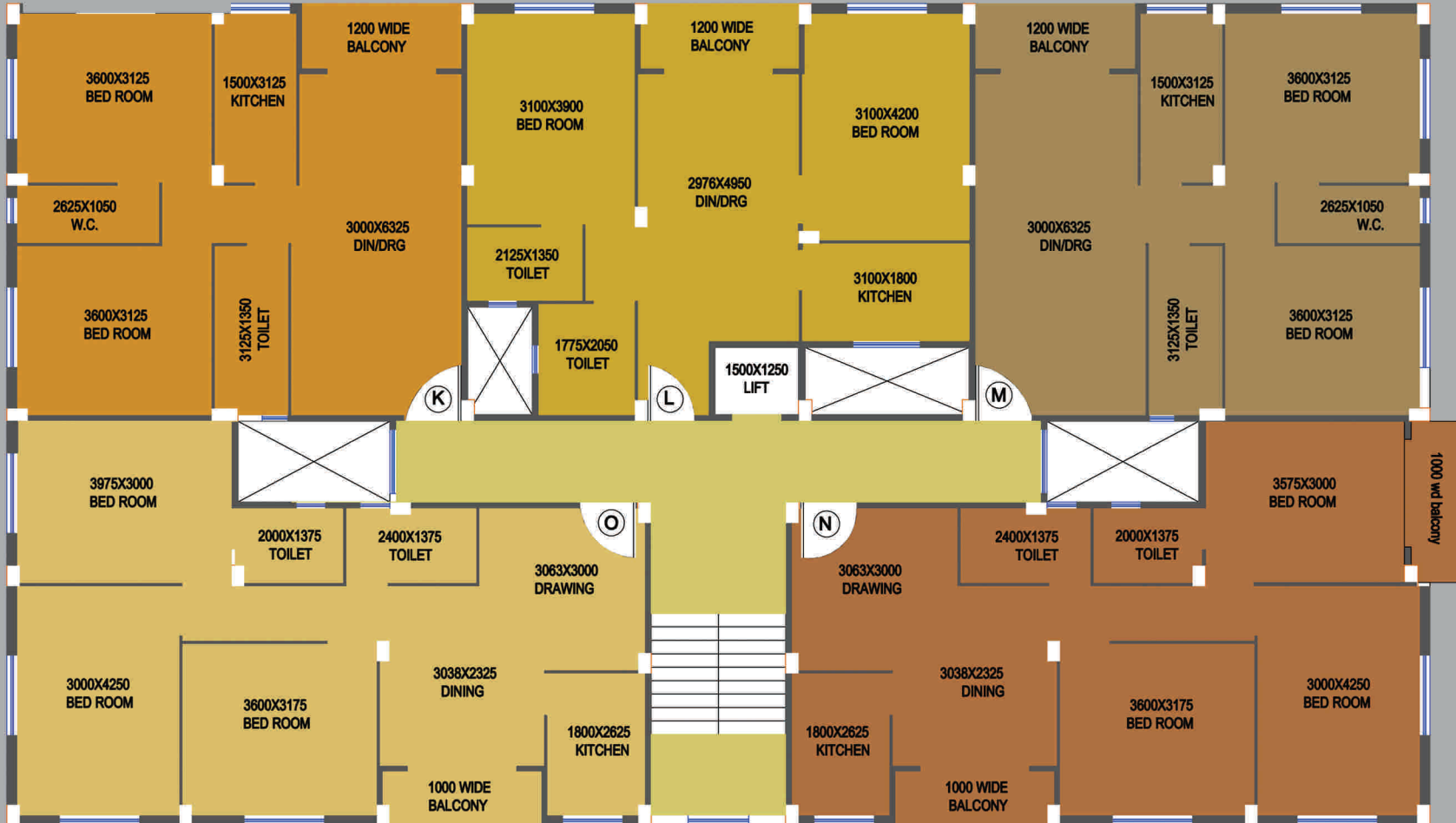

K-972 SQ.FT | L-944 SQ.FT | M-972 SQ.FT | N-1195SQ.FT | O-1195 SQ.FT

TYPICAL FLOOR PLAN OF BLOCK - 4

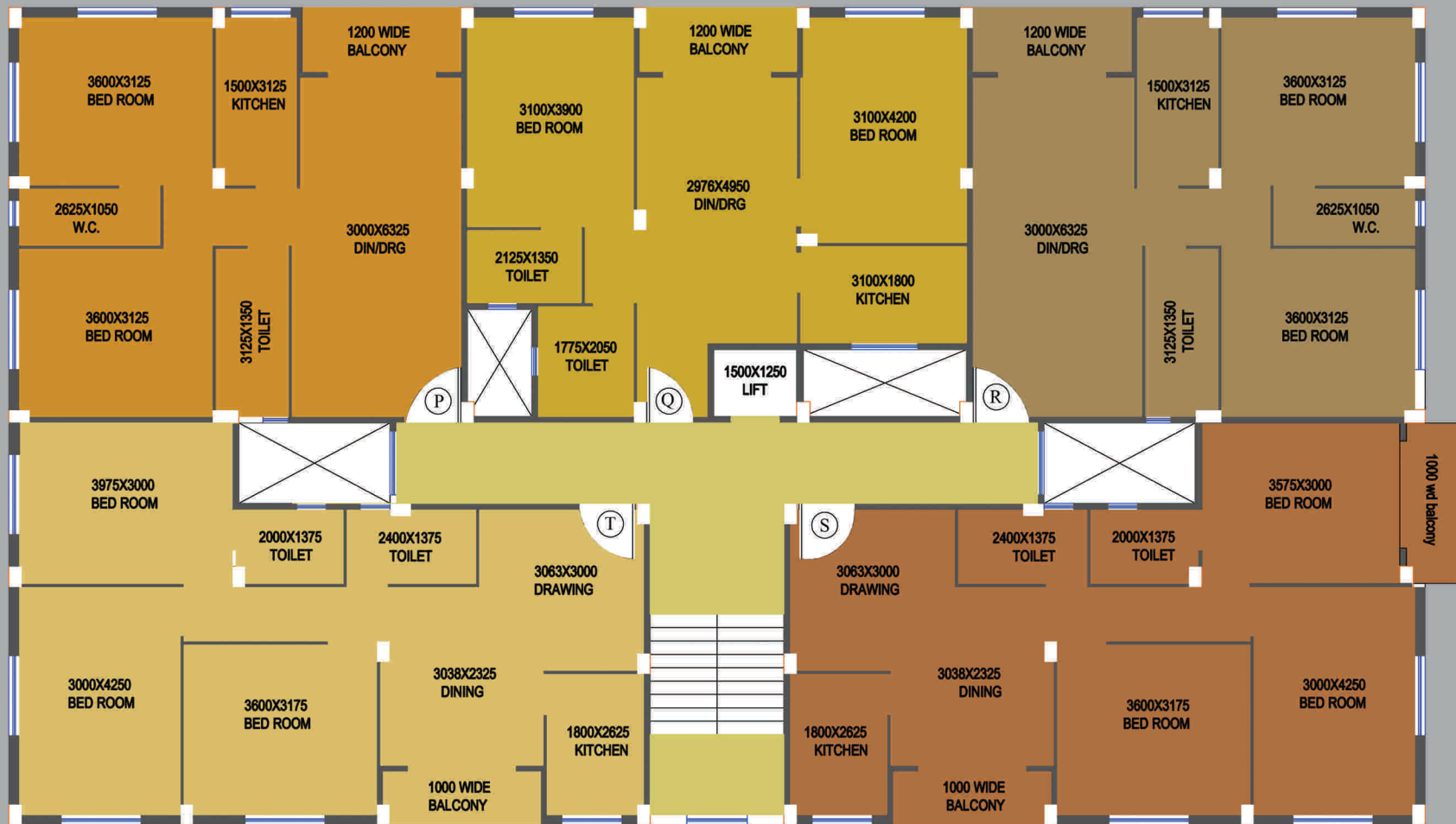

P-972 SQ.FT | Q-944 SQ.FT | R-972 SQ.FT | S-1195 SQ.FT | T-1195 SQ.FT



TYPICAL FLOOR PLAN OF BLOCK - 5,6

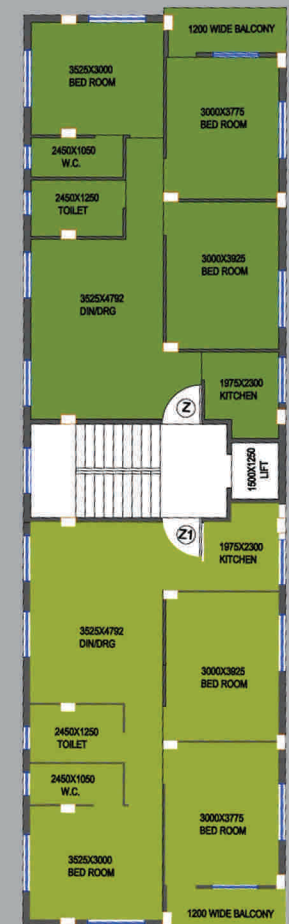

U-972 SQ.FT | V-944 SQ.FT | W-972 SQ.FT | X-1195 SQ.FT | Y-1195 SQ.FT
Z-1162 SQ.FT | Z1-1162 SQ.FY



DREAM
COMES
REAL



Sapphire
Gardens



Sapphire
Gardens

Rajarhate Projar Bass



Developer -



www.510earth.com

OFFICE: Stesalit Towers, Office #7, 4th floor Plot
No E2-3, Block - EP & GP, Sector V, Salt Lake,
Kolkata - 700091

Call Us +91-9073338396

Engineer -

Asit Kumar Roy Choudhury

Legal Advisor -

Saha & Ray Advocates



All information, dimensions, features & offerings in this brochure are subject to change without notice.
Pictures used in this brochure are for illustration only and may vary from final features and actual offerings.
this is a promotional, not a formal offering or a legal document.